

LAD7 305 / 310

www.schneider-electric.com

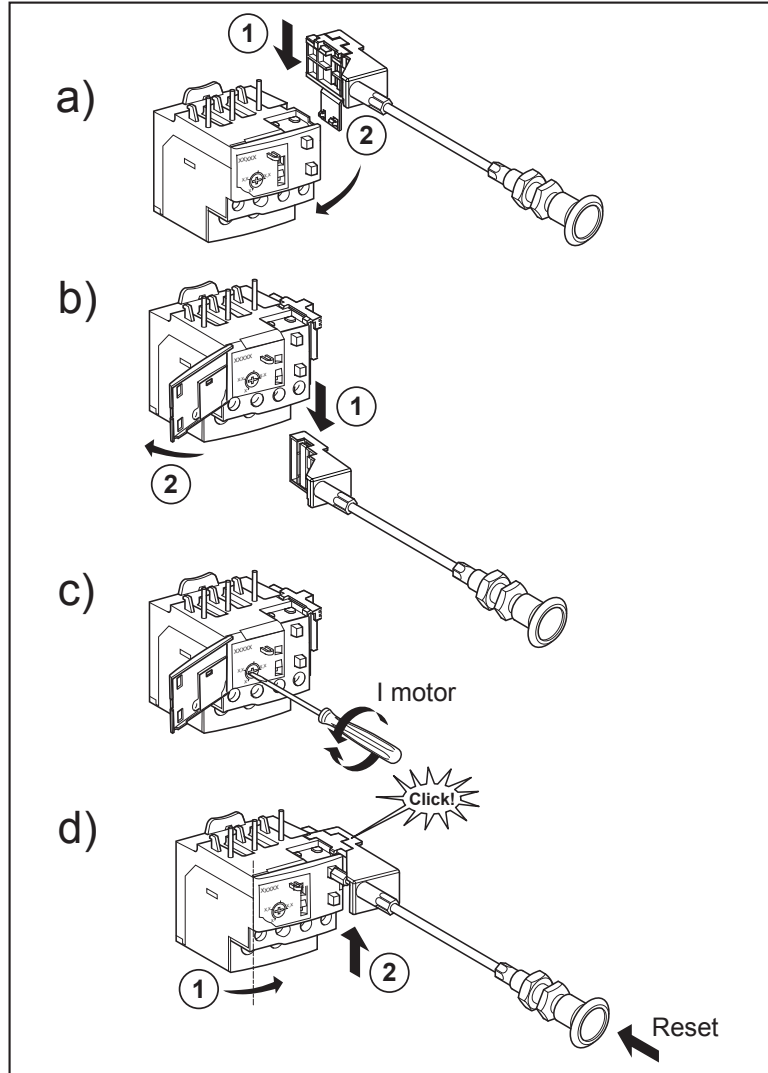

W9 1636596 0111 A05
07 - 2010
1/1

Schneider
Electric

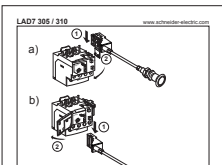

Article / Part : W9 1636596 0111 A05

Impression noire , sur feuille couche mat 64g/m² minimum
de couleur blanche , format A5 mm .
Black print in white paper 64g/m² , format A5 .

L'impression sera centrée sur la feuille avec un precision de ± 1 mm .
The printing will focus on the sheet with an accuracy of ± 1 mm .

Format de pliage / Format folding : 148.5
A6 (148.5 x 105 mm) .

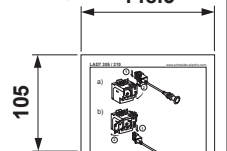

AN187818 Makuc/Bouchard 05 Ajout référence LAD7310

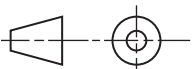

Scale :
1:1

Tolerancing Standard :

Units of measure :
mm

Schneider
Electric

LAD7 305 : INSTRUCTION DE SERVICE .
LAD7 305 : INSTRUCTION SHEET .

Number :

163659601A50

Rev :
05

Sheet :
01 / 01